



66 Moorfield Road Leeds



3 Bedroom House - Semi-Detached £199,995

69 Lower Wortley Road
Wortley
Leeds
West Yorkshire
LS12 4SL
Tel: 0113 231 1033
Fax: 0113 203 8333

Web Site
www.kathwells.com

email
sales@kathwells.com

66 Moorfield Road, Leeds, West Yorkshire, LS12 3RS

GROUND FLOOR:

Hallway:



Access via a part glazed front entrance door, stairs rising to the first floor, central heating radiator

Living Room:



Double glazed window, central heating radiator, television point, ample space for a range of living room furniture

Fitted Kitchen / Diner:



Double glazed window, part glazed rear door, a range of fitted wall, drawer & base units, work surfaces, four burner gas hob with an extractor fan above, integral oven / grill, an inset sink & drainer, ample space for a fridge / freezer

Landing:

Double glazed window, access to first floor accommodation, access to loft space

Bedroom One:



Double glazed window, central heating radiator, built in wardrobes, ample space for a range of bedroom furniture

Bedroom Two:



Double glazed window, central heating radiator, built in wardrobes, ample space for bedroom furniture

Bedroom Three:



Double glazed window, central heating radiator

Shower Room:



Double glazed window, electric shower, wash basin, ladder style central heating radiator

Seperate WC:



Double glazed window, low flush WC

TO THE OUTSIDE:

Gardens:



The front garden has a small artificial lawn and is low maintenance. The rear garden has an artificial and is also low maintenance.

Off Street Parking / Driveway / Garge:

A driveway provides useful off street parking for 3 cars. The garage provides a useful storage space.

EPC Link:

<https://find-energy-certificate.service.gov.uk/energy-certificate/0998-0207-6806-3211-2900>

Council Tax Band & EPC Rating:

Council Tax Band: B / EPC Rating: D

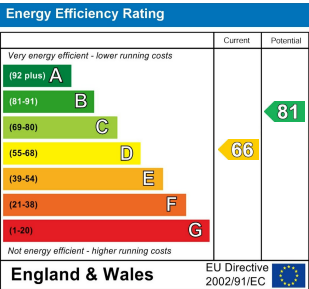

Ground Floor

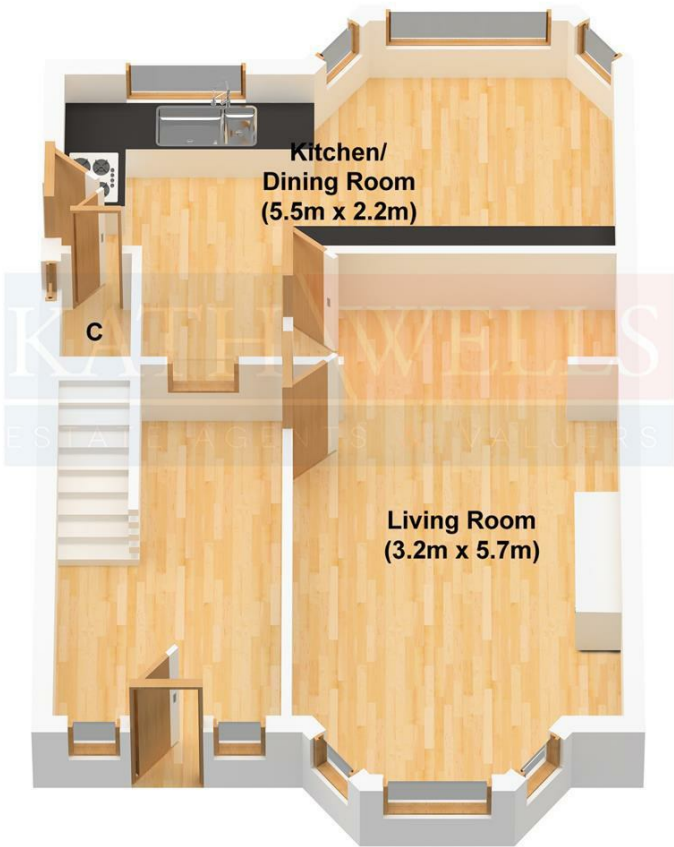

First Floor

